

A2100152P176S
 SINGLE LINE ARRAY, 2 POS.
 1,500pF Cap. "Pi" Feed-Thru

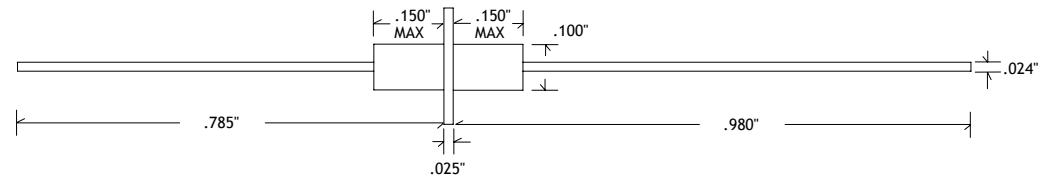
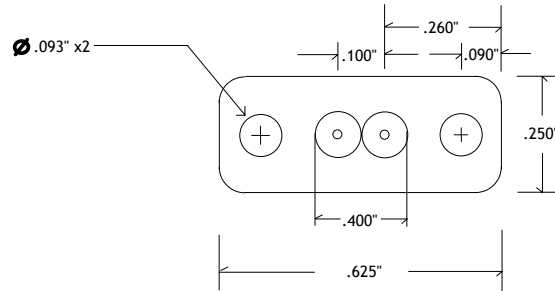
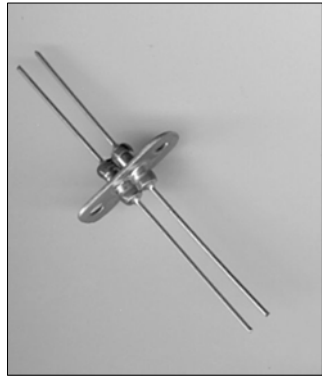

PART NUMBER	EMI P/N	CAP. (pF)	MAX. WVDC	DC AMPS	MINIMUM NO LOAD INSERTION LOSS			
					1 MHz	10 MHz	100 MHz	1 GHz
A2100152P176S		1,500	100	5	4	13	56	83

CAPACITANCE TOLERANCE: +100/-0%
 DISSIPATION FACTOR: 3.5% MAX.
 INSULATION RESISTANCE:
 25 °C=1000 MΩμF Min.
 125° C=100 MΩμF Min.
 DIELECTRIC STRENGTH (DWV):
 250% of WVDC (5 seconds)
 TEMPERATURE CHARACTERISTIC:
 Z5U or better

DIMENSION TOLERANCE:
 CASE LENGTH: +/- .005" (.123mm)
 LEAD LENGTH: +/- .030" (.762mm)
 LEAD DIAMETER: +/- .002" (.051mm)

MATERIAL AND FINISH:
 GROUND PLANE: Brass FINISH: Tin
 LEAD MATERIAL: Copper alloy
 LEAD FINISH: Tin

MARKING: None
 OPERATING TEMP: -35° C to +85° C
 INSTALLATION TEMP: N/A

* ISO 9001:2008 Registered

EMI Filter Company 12750 59th Way N. Clearwater, FL 33760 (727) 585-7990 (727) 586-5138 Fax www.emifiltercompany.com		FILTER PLATE, EMI 2 LINE, .100" SPACING	
FSCM NO.	DWG NO. A2100152P176S REV. C	REV C	